

TECHNICAL INFORMATION

BEAM SPIGOT BS0005

TIS17013-



PRODUCT DIMENSIONS

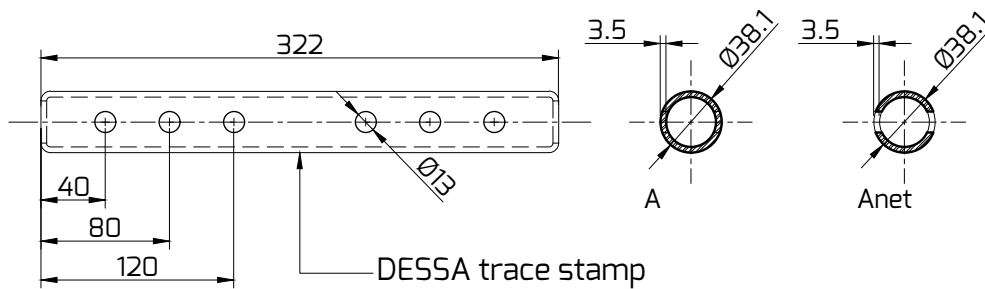

ARTICLE	DESCRIPTION	WEIGHT (kg)	SECTION PROPERTIES	MATERIAL
BS0005	Beam Spigot ASTX 6HS	0.72	D = 38.10 mm T = 3.50 mm A = 380.45 mm ² A _{net} = 287.13 mm ²	S355 steel F _y = 355 N/mm ² F _u = 510 N/mm ² E = 210000 N/mm ²

LOADING	PERMISSIBLE LOAD
Tension*	81.85 kN
Bending	0.90 kNm
Shear (single)	30.09 kN

*Assuming a 3 pin connection per side of spigot.

USED WITH
DESSA ASTERIX, DESSA D75, COVERSPAN, ALTRIX UK, ALTRIX FR BEAMS

The information provided is based on prevailing legislation and/or testing. DESSA Ltd reserves the right to make technical changes, users should ensure that only current revisions of this Technical Information Sheet are used. The published data refers to original genuine DESSA materials only. © DESSA Limited. No unauthorised use, copy or disclosure is to be made.