

PRODUCT GUIDANCE

ASTERIX 75CM BEAMS

PDG11002-

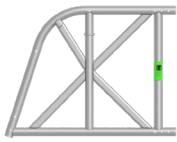

BC0118

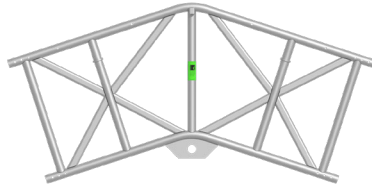

BC0018



BC0600

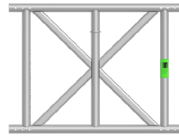

BC1000

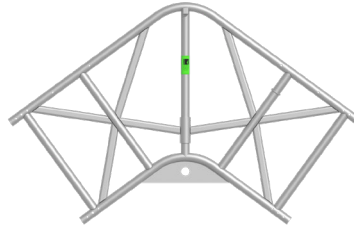

BC0036

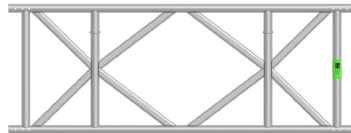

BC2000

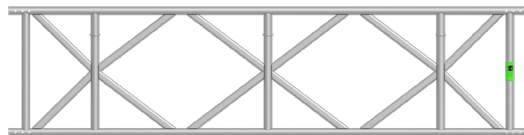

BC3000



BC4000

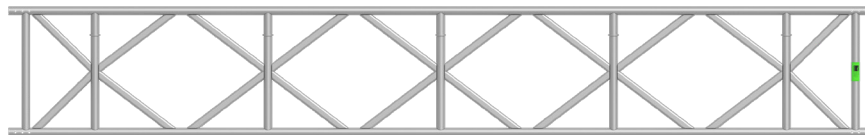

BC5000



BC6000

ARTICLE	DESCRIPTION	WEIGHT (kg)
BC0018	ASTERIX ridge beam 18°	9.5
BC0036	ASTERIX ridge beam 36°	9.9
BC0118	ASTERIX eaves beam 0.75x18°	7.4
BC0600	ASTERIX aluminium beam 0.75x0.6m	4.8
BC1000	ASTERIX aluminium beam 0.75x1.0m	7.9

ARTICLE	DESCRIPTION	WEIGHT (kg)
BC2000	ASTERIX aluminium beam 0.75x2.0m	13.9
BC3000	ASTERIX aluminium beam 0.75x3.0m	19.8
BC4000	ASTERIX aluminium beam 0.75x4.0m	25.7
BC5000	ASTERIX aluminium beam 0.75x5.0m	31.7
BC6000	ASTERIX aluminium beam 0.75x6.0m	37.6

The information provided is based on prevailing legislation and/or testing. DESSA Ltd reserves the right to make technical changes, users should ensure that only current revisions of this Product Guidance are used. The published data refers to original genuine DESSA materials only. © DESSA Limited. No unauthorised use, copy or disclosure is to be made.